

ROAD TO IELTS

IELTS preparation and practice



Listening

Practice test 3

Candidate Number

Candidate Name _____

INTERNATIONAL ENGLISH LANGUAGE TESTING SYSTEM

Listening

PRACTICE TEST 3

40 minutes

Time 40 minutes

INSTRUCTIONS TO CANDIDATES

Do not open this question paper until you are told to do so.

Write your name and candidate number in the spaces at the top of this page.

Listen to the instructions for each part of the paper carefully.

Answer all the questions.

While you are listening, write your answers on the question paper.

You will have 10 minutes at the end of the test to copy your answers onto the separate answer sheet. Use a pencil.

At the end of the test, hand in this question paper.

INFORMATION FOR CANDIDATES

There are **four** parts to the test.

You will hear each part **once** only.

There are **40** questions.

Each question carries one mark.

For each part of the test, there will be time for you to look through the questions and time for you to check your answers.

SECTION 1 Questions 1–10

Questions 1–5

Complete the notes below.

Write **NO MORE THAN ONE WORD AND/OR A NUMBER** for each answer.

Second-hand Bedroom Furniture for Sale

<i>Example</i>	<i>Answer</i>
Number of items for sale:	<u>three</u>

Bedside tables

Construction: wood

Colour: **1**

Drawers: two (in each table)

 handles made of **2**

Height: **3** cm

Condition: **4**

Price: **5** (for both)

ROAD TO IELTS
www.takeIELTS.britishcouncil.org

Questions 6–10

Complete the notes below.

Write **NO MORE THAN ONE WORD AND/OR A NUMBER** for each answer.

Dressing table

Drawers: five (two are **6**

Width: **7**

Mirrors: three: one large, two small (all
8

Condition: good

Price: **9**

Seller's details

Name: Carolyn Kline

Address: **19 10** Road

SECTION 2

Questions 11–20

Questions 11–17

Label the plan below.

Write the correct letter, A–J, next to questions 11–17.

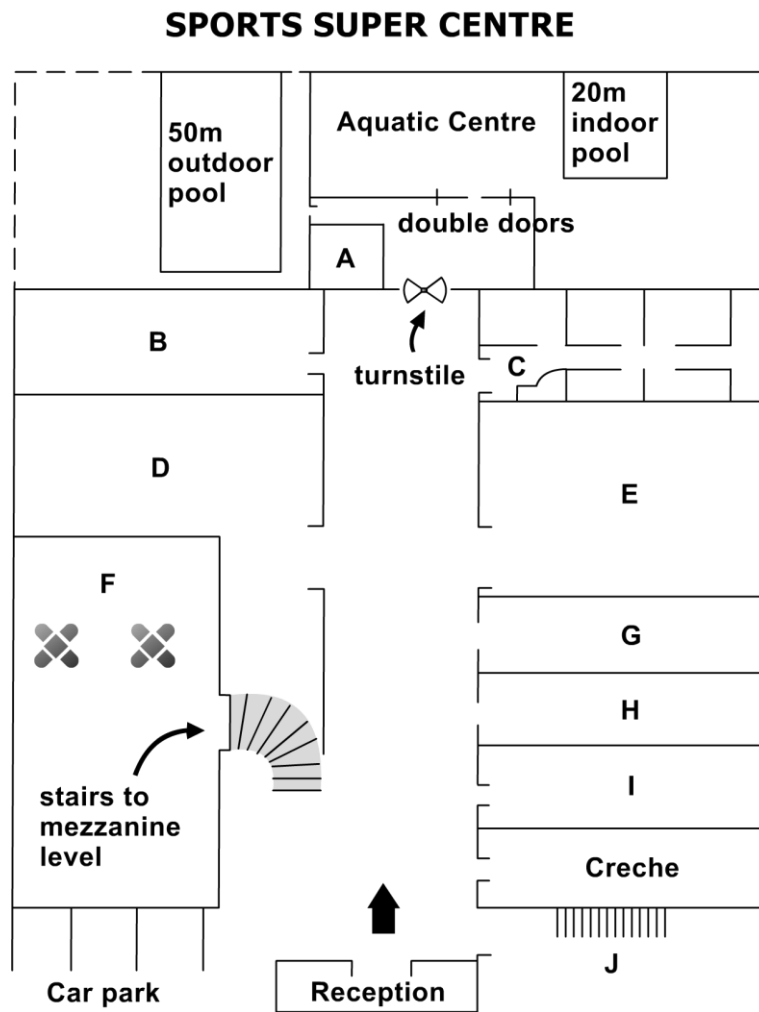

- 11 Administration office
- 12 Sports medicine clinic
- 13 Bike racks
- 14 Café
- 15 Conference room
- 16 Men's locker room
- 17 Pool shop

Question 18

Choose the correct letter, **A**, **B** or **C**.

18 The sports centre is open on public holidays from

- A** 7 a.m. to 5 p.m.
- B** 5 a.m. to 7 p.m.
- C** 5 a.m. to 9 p.m.

Questions 19 and 20

Choose **TWO** letters, **A–E**.

Which **TWO** services are covered by the membership fee?

- A** Personal training
- B** Swim squads
- C** Childminding
- D** Programme design
- E** Tennis lessons

SECTION 3

Questions 21–30

Questions 21–25

Complete the notes below.

*Write **NO MORE THAN TWO WORDS** for each answer.*

Part One - Checklist:

- Write an **21** – keep it brief.
- List relevant **22**
- Have two academic advisors read over your **23**
- Choose the journal you want to submit to.
- Apply the journal's **24** to your article.
- Sign the **25**

Questions 26–30

Complete the flow-chart below.

Write **NO MORE THAN TWO WORDS** for each answer.

Part Two - Process

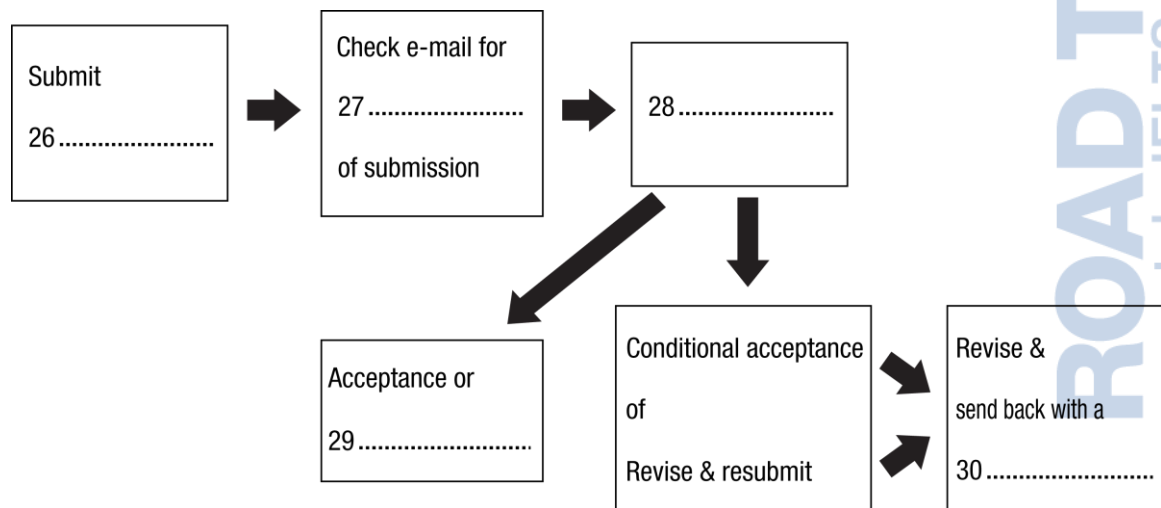

SECTION 4 Questions 31–40

Questions 31–33

Complete the summary below.

Write **NO MORE THAN TWO WORDS** for each answer.

If soil is healthy, it is a **31** teeming with life such as worms, fungi and bacteria. If plants are grown in poor soil, they will lack **32** and human health will suffer. Plants are nourished by organic matter, **33** and other essential elements which are broken down by insects and other organisms in a synergistic relationship.

Questions 34–36

Label the diagram below.

Write **NO MORE THAN TWO WORDS** for each answer.

Layers of Soil

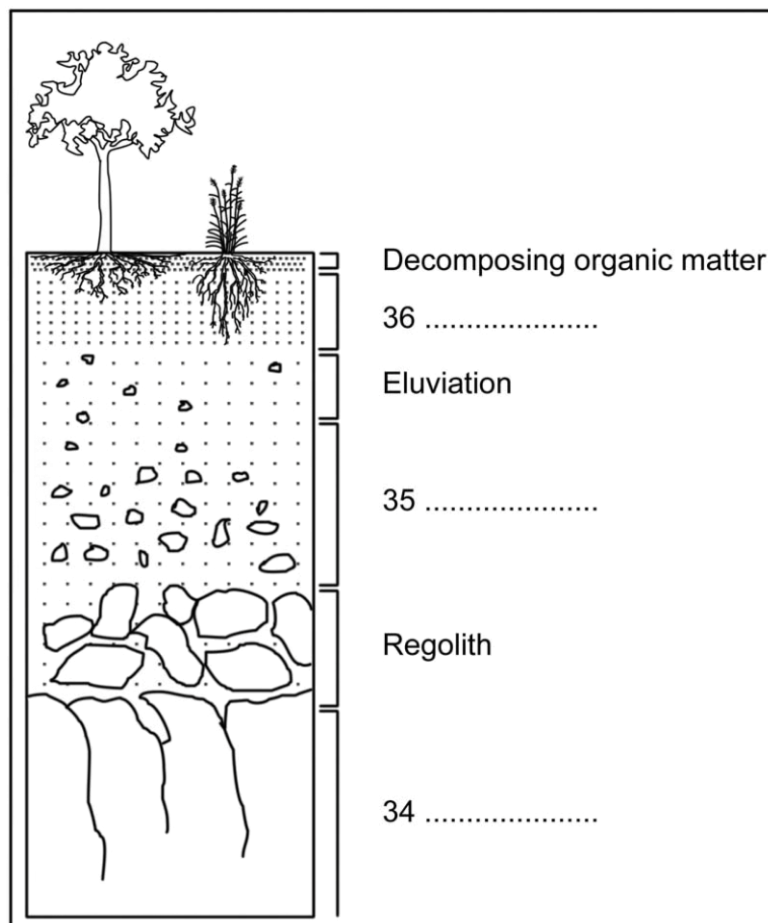

Questions 37–40

Complete the notes below.

Write **NO MORE THAN TWO WORDS** for each answer.

Problems:

- Erosion
- **37** from various sources, including chemical fertilisers

Conventional farming methods	Organic farming methods
<ul style="list-style-type: none">• monoculture• synthetic fertiliser & chemicals used for 38• genetically-modified seeds• pesticide & fungicide sprayed on crops after picking• no need for documentation of 39.....	<ul style="list-style-type: none">• crop rotation• covering crops• use of insects as natural 40• addition of manure & green waste

Family name: _____

First name(s): _____

Are you: Female? Male?

Listening Listening Listening Listening Listening Listening

		Marker use only			Marker use only
1		✓ 1 X <input type="checkbox"/> <input type="checkbox"/>	21		✓ 21 X <input type="checkbox"/> <input type="checkbox"/>
2		✓ 2 X <input type="checkbox"/> <input type="checkbox"/>	22		✓ 22 X <input type="checkbox"/> <input type="checkbox"/>
3		✓ 3 X <input type="checkbox"/> <input type="checkbox"/>	23		✓ 23 X <input type="checkbox"/> <input type="checkbox"/>
4		✓ 4 X <input type="checkbox"/> <input type="checkbox"/>	24		✓ 24 X <input type="checkbox"/> <input type="checkbox"/>
5		✓ 5 X <input type="checkbox"/> <input type="checkbox"/>	25		✓ 25 X <input type="checkbox"/> <input type="checkbox"/>
6		✓ 6 X <input type="checkbox"/> <input type="checkbox"/>	26		✓ 26 X <input type="checkbox"/> <input type="checkbox"/>
7		✓ 7 X <input type="checkbox"/> <input type="checkbox"/>	27		✓ 27 X <input type="checkbox"/> <input type="checkbox"/>
8		✓ 8 X <input type="checkbox"/> <input type="checkbox"/>	28		✓ 28 X <input type="checkbox"/> <input type="checkbox"/>
9		✓ 9 X <input type="checkbox"/> <input type="checkbox"/>	29		✓ 29 X <input type="checkbox"/> <input type="checkbox"/>
10		✓ 10 X <input type="checkbox"/> <input type="checkbox"/>	30		✓ 30 X <input type="checkbox"/> <input type="checkbox"/>
11		✓ 11 X <input type="checkbox"/> <input type="checkbox"/>	31		✓ 31 X <input type="checkbox"/> <input type="checkbox"/>
12		✓ 12 X <input type="checkbox"/> <input type="checkbox"/>	32		✓ 32 X <input type="checkbox"/> <input type="checkbox"/>
13		✓ 13 X <input type="checkbox"/> <input type="checkbox"/>	33		✓ 33 X <input type="checkbox"/> <input type="checkbox"/>
14		✓ 14 X <input type="checkbox"/> <input type="checkbox"/>	34		✓ 34 X <input type="checkbox"/> <input type="checkbox"/>
15		✓ 15 X <input type="checkbox"/> <input type="checkbox"/>	35		✓ 35 X <input type="checkbox"/> <input type="checkbox"/>
16		✓ 16 X <input type="checkbox"/> <input type="checkbox"/>	36		✓ 36 X <input type="checkbox"/> <input type="checkbox"/>
17		✓ 17 X <input type="checkbox"/> <input type="checkbox"/>	37		✓ 37 X <input type="checkbox"/> <input type="checkbox"/>
18		✓ 18 X <input type="checkbox"/> <input type="checkbox"/>	38		✓ 38 X <input type="checkbox"/> <input type="checkbox"/>
19		✓ 19 X <input type="checkbox"/> <input type="checkbox"/>	39		✓ 39 X <input type="checkbox"/> <input type="checkbox"/>
20		✓ 20 X <input type="checkbox"/> <input type="checkbox"/>	40		✓ 40 X <input type="checkbox"/> <input type="checkbox"/>

Marker 2 Initials

Marker 1 Initials

Band Score

Listening Total